

SURVEYING AND SPATIAL INFORMATION REGULATION ACT 2012: CLAUSE 35(1)(b) & CLAUSE 61(2)

MARK	M.G.A. CO-ORDINATES		HORIZ. CLASS	HORIZ. ORDER	METHOD	ORIGIN
	EASTING	NORTHING				
P.M. 4198	730567.873	6294787.313	A	1	FROM S.C.I.M.S.	S.C.I.M.S.
S.S.M. 128714	728922	6293603	U	U	HANDHELD G.N.S.S.	
S.S.M. 128715	728985	6293421	U	U	HANDHELD G.N.S.S.	

SOURCE: M.G.A. CO-ORDINATES SUPPLIED BY LAND AND PROPERTY INFORMATION S.C.I.M.S. DATED 5th SEPTEMBER 2012. ZONE 55

NOTE: S.C.I.M.S. COORDINATES ARE NOT CORRECT FOR S.S.M. 128714 AND S.S.M. 128715 AS AT 5/9/2012. AN UPDATED STATUS REPORT WAS SENT TO S.C.I.M.S. ON 23/3/2013

P.M. / S.S.M. CONNECTIONS

FROM	TO	BEARING	DISTANCE
P.M. 4198	S.S.M. 128715	218°42'50"	2091.345
P.M. 4198	S.S.M. 128714	223°45'50"	2027.520
S.S.M. 128715	S.S.M. 128714	330°36'02"	192.331 (DATUM LINE)

REFERENCE MARKS

COR.	BEARING	DIST.	FROM	ORIGIN
A	149°13'	1.0	G.I. PIPE FD.	D.P. 590823
B	261°02'	1.77	G.I. PIPE FD.	D.P. 1064924
C	274°48'30"	6.78	G.I. PIPE FD.	D.P. 1064924
D	61°02'	5.705	G.I. PIPE	ME
E	105°36'10"	29.035	G.I. PIPE	ME
F	170°59'30"	2.295	G.I. PIPE	ME
G	91°46'50"	6.62	G.I. PIPE	ME
H	108°55'	0.455	G.I. PIPE FD.	R23566-1603
I	282°37'	8.725	G.I. PIPE	ME
J	228°55'50"	1.625	G.I. PIPE FD.	R23566-1603
K	257°43'	7.43	G.I. PIPE	ME
L	153°27'	0.455	G.I. PIPE FD.	R23566-1603
M	218°46'55"	3.68	P.M. 4198 FD.	D.P. 1042933
N	307°49'05"	2.14	G.I. PIPE FD.	D.P. 1042933
O	269°02'40"	0.8	G.I. PIPE FD.	D.P. 1042933
P	72°41'45"	1.005	G.I. PIPE FD.	D.P. 159101
Q	289°14'30"	0.945	G.I. PIPE FD.	D.P. 716032
R	88°11'40"	1.0	G.I. PIPE FD.	D.P. 590823
S	20°17'25"	6.605	G.I. PIPE FD.	D.P. 1064924
T	160°24'20"	2.695	G.I. PIPE FD.	D.P. 1064924
U	283°52'50"	1.45	G.I. PIPE FD.	D.P. 116230
V	148°29'50"	1.15	G.I. PIPE FD.	D.P. 1064924
W	90°24'	27.5	S.S.M. 128715 FD.	D.P. 1064924
X	11°57'10"	27.835	S.S.M. 128714 FD.	D.P. 1064924
Y	288°41'	0.455	G.I. PIPE FD.	R23382-1603

DATUM LINE

S.S.M. 128715 - S.S.M. 128714
330°36'02" 192.331 BY SURVEY
330°36'02" 192.328 BY D.P. 1064924

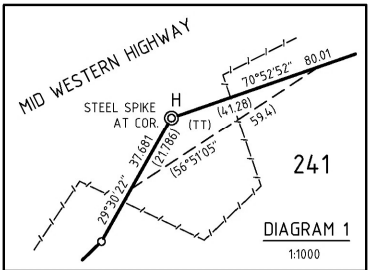

(TT) EASEMENT FOR TRANSMISSION LINE (GOV. GAZ. 18/3/1932 FOLIO 1000) (PLAN 2122-3090)
 (X) BENEFITED BY RIGHT OF CARRIAGEWAY 20 WIDE -3249192.

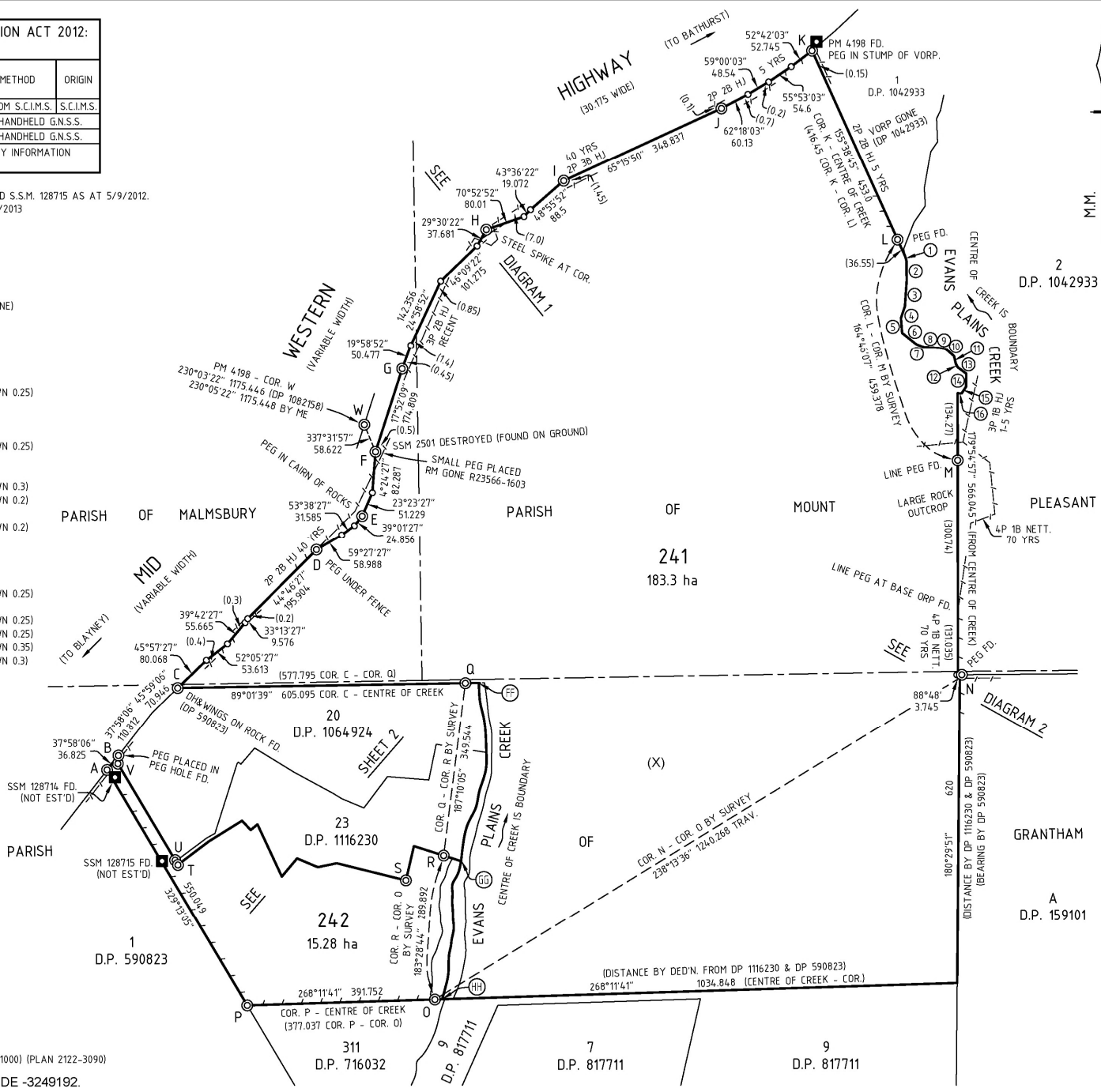

CENTRE OF CREEK PO D.P. 1042933

LINE	BEARING	DISTANCE
1	163°17'	9.275
2	179°22'20"	40.445
3	183°51'20"	51.185
4	199°02'20"	24.89
5	175°15'20"	29.945
6	128°39'20"	36.485
7	111°25'50"	14.68
8	94°10'20"	32.74
9	100°19'20"	13.14
10	130°56'50"	21.81
11	166°57'20"	15.53
12	153°52'10"	8.15
13	126°15'55"	21.73
14	180°58'55"	26.605
15	214°02'40"	15.915
16	272°35'20"	8.08

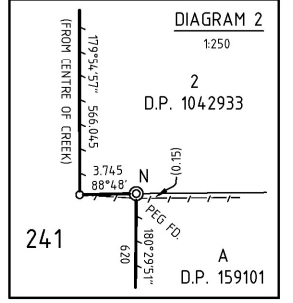

CENTRE OF CREEK: FF - GG PO D.P. 1064924

LINE	BEARING	DISTANCE
FF	175°21'10"	4.7285
18	165°37'35"	18.83
19	171°51'	30.52
20	177°10'30"	35.715
21	178°34'40"	9.665
22	178°34'40"	16.22
23	184°24'25"	17.985
24	195°32'30"	26.26
25	198°27'15"	20.455
26	191°15'45"	29.55
27	205°46'20"	37.67
28	196°17'	26.23
29	189°04'50"	21.01
GG	186°41'	29.97

CENTRE OF CREEK: GG - HH BY SURVEY

LINE	BEARING	DISTANCE
GG	190°22'	10.45
31	199°17'30"	22.345
32	208°22'30"	16.965
33	178°59'	20.0
34	184°09'	8.54
35	181°33'	8.41
36	175°00'30"	16.735
37	178°40'40"	17.285
38	172°57'30"	10.38
39	181°12'30"	12.73
40	191°58'40"	19.545
41	186°28'	12.175
42	192°18'45"	12.6
43	184°27'50"	22.42
44	181°36'40"	20.545
45	192°16'30"	29.745
46	195°08'15"	23.15
HH		

SURVEYOR: MARGUS ALEXANDER RATSEP
 of Voerman & Ratsep, P.O. Box 16, Bathurst N.S.W. 2795
 DATE OF SURVEY: 19th DECEMBER 2012
 2013M7100 (608 PARTIAL SURVEY)
 SURVEYOR'S REFERENCE: 904703LTDH REPORT(IV)

PLAN OF: SUBDIVISION OF LOT 1 IN D.P. 137310, LOT 1 IN D.P. 137319 AND LOT 24 IN D.P. 1116230, AND RELEASE OF EASEMENT AFFECTING LOT 20 IN D.P. 1064924 AND LOT 23 IN D.P. 1116230

L.G.A: BATHURST REGIONAL
 Locality: EVANS PLAINS
 Subdivision No.: 2013/83
 Lengths are in metres. Reduction Ratio 1:6000

Registered
 28.6.2013

DP1185616

Box:e-DeX /Doc:DP 1185616 P /Rev:28-Jun-2013 /Sta:SC.OK /Prt:29-Jun-2013 01:35 /Pgs:ALL /Seq:1 of 5
 WARNING : Electronic Document supplied by LPI NSW for Your Internal Use Only.

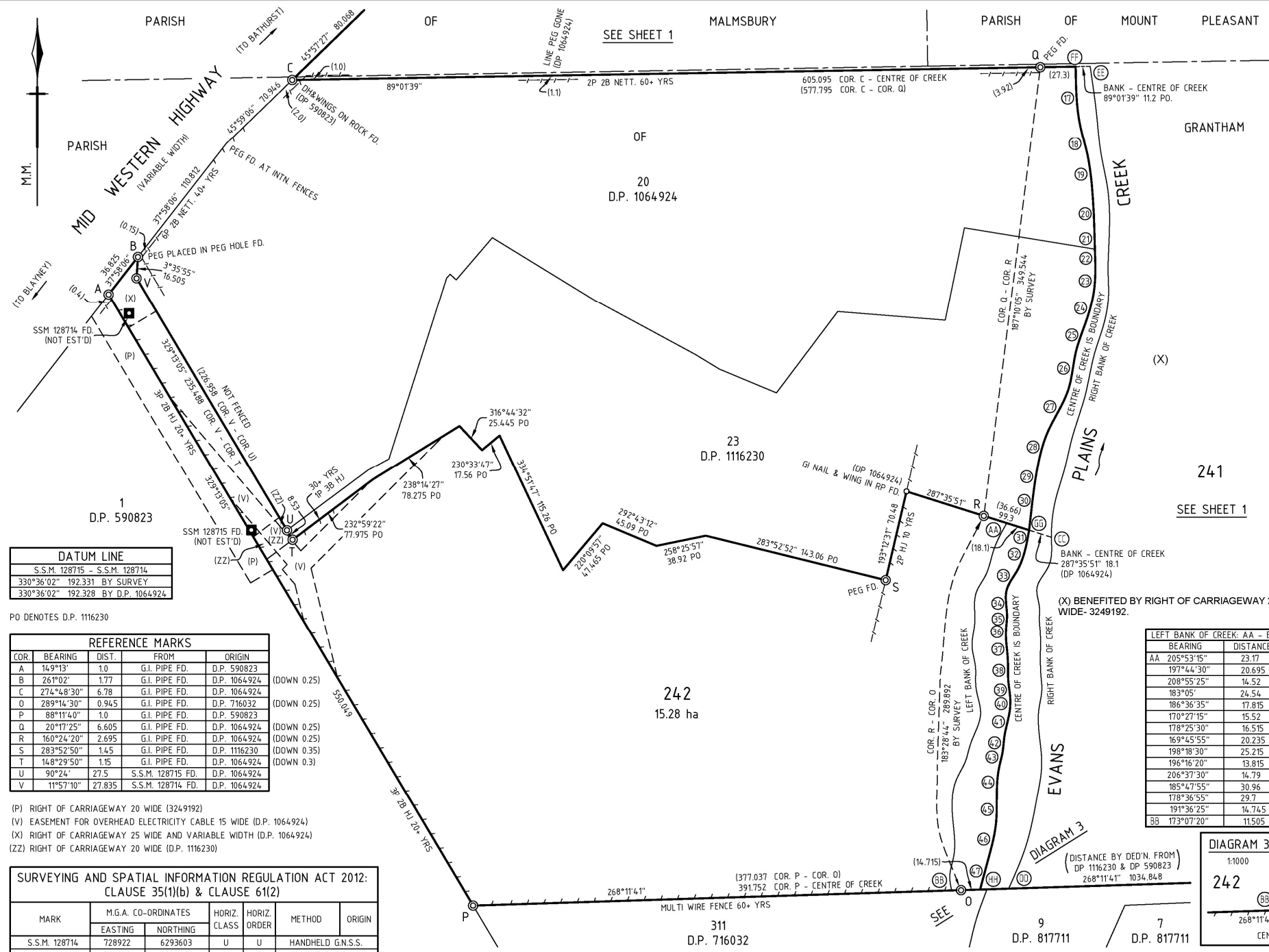

DATUM LINE	
S.S.M. 128715 - S.S.M. 128714	
330°36'02" 192.331	BY SURVEY
330°36'02" 192.328	BY D.P. 1064924

REFERENCE MARKS				
COR.	BEARING	DIST.	FROM	ORIGIN
A	149°13'	1.0	G.I. PIPE FD.	D.P. 590823
B	26°102'	1.77	G.I. PIPE FD.	D.P. 1064924
C	274°48'30"	6.78	G.I. PIPE FD.	D.P. 1064924
D	289°14'30"	0.945	G.I. PIPE FD.	D.P. 716032
P	88°11'40"	1.0	G.I. PIPE FD.	D.P. 590823
Q	20°17'25"	6.605	G.I. PIPE FD.	D.P. 1064924
R	160°24'20"	2.695	G.I. PIPE FD.	D.P. 1064924
S	283°52'50"	1.45	G.I. PIPE FD.	D.P. 1116230
T	148°29'50"	1.15	G.I. PIPE FD.	D.P. 1064924
U	90°24'	27.5	S.S.M. 128715 FD.	D.P. 1064924
V	11°57'10"	27.835	S.S.M. 128714 FD.	D.P. 1064924

(P) RIGHT OF CARRIAGEWAY 20 WIDE (324.9192)
 (V) EASEMENT FOR OVERHEAD ELECTRICITY CABLE 15 WIDE (D.P. 1064924)
 (X) RIGHT OF CARRIAGEWAY 25 WIDE AND VARIABLE WIDTH (D.P. 1064924)
 (ZZ) RIGHT OF CARRIAGEWAY 20 WIDE (D.P. 1116230)

SURVEYING AND SPATIAL INFORMATION REGULATION ACT 2012: CLAUSE 35(1)(b) & CLAUSE 61(2)

MARK	M.G.A. CO-ORDINATES		HORIZ. CLASS	HORIZ. ORDER	METHOD	ORIGIN
	EASTING	NORTHING				
S.S.M. 128714	728922	6293603	U	U	HANDHELD G.N.S.S.	
S.S.M. 128715	728985	6293421	U	U	HANDHELD G.N.S.S.	

SOURCE: M.G.A. CO-ORDINATES SUPPLIED BY LAND AND PROPERTY INFORMATION S.C.I.M.S. DATED 5th SEPTEMBER 2012. ZONE 55

NOTE: S.C.I.M.S. COORDINATES ARE NOT CORRECT FOR S.S.M. 128714 AND S.S.M. 128715 AS AT 5/9/2012. AN UPDATED STATUS REPORT WAS SENT TO S.C.I.M.S. ON 23/3/2013

SURVEYOR: MARGUS ALEXANDER RATSEP
 of Voerman & Ratsep, P.O. Box 16, Bathurst N.S.W. 2795
 DATE OF SURVEY: 19th DECEMBER 2012
 2013M7100 (608 PARTIAL SURVEY)
 SURVEYOR'S REFERENCE: 904703LTDH REPORT(V)

PLAN OF: SUBDIVISION OF LOT 1 IN D.P. 137310,
 LOT 1 IN D.P. 137319 AND LOT 24 IN D.P. 1116230,
 AND RELEASE OF EASEMENT AFFECTING LOT 20
 IN D.P. 1064924 AND LOT 23 IN D.P. 1116230

L.G.A: BATHURST REGIONAL
 Locality: EVANS PLAINS
 Subdivision No.: 2013/83
 Lengths are in metres. Reduction Ratio 1: 2000

Registered
 28.6.2013

DP1185616

CENTRE OF CREEK: FF - GG BY SURVEY		
LINE	BEARING	DISTANCE
FF	17	175°21'10" 4.7285
	18	165°37'35" 18.83
	19	171°15" 30.52
	20	177°10'30" 35.715
	21	178°34'40" 9.665
	22	178°34'40" 16.22
	23	184°24'25" 17.985
	24	195°32'30" 26.26
	25	198°27'15" 20.455
	26	191°15'45" 29.55
	27	205°46'20" 37.67
	28	196°17' 26.23
	29	189°04'50" 21.01
GG	30	186°4'1" 29.97



CENTRE OF CREEK: GG - HH BY SURVEY		
LINE	BEARING	DISTANCE
GG	31	190°22' 10.45
	32	199°17'30" 22.345
	33	208°22'30" 16.965
	34	178°59' 20.0
	35	184°09' 8.54
	36	181°33' 8.41
	37	175°00'30" 16.735
	38	178°40'40" 17.285
	39	172°57'30" 10.38
	40	181°12'30" 12.73
	41	191°58'40" 19.545
	42	186°28' 12.175
	43	192°48'45" 12.4
	44	184°27'50" 22.42
	45	181°36'40" 20.545
	46	192°16'30" 29.745
HH	47	195°08'15" 23.15

RIGHT BANK OF CREEK: EE - CC BY SURVEY	
BEARING	DISTANCE
EE	172°26'45" 38.69
	173°38'40" 29.01
	169°09'50" 26.94
	177°52'20" 36.975
	181°43'25" 29.175
	179°00'25" 17.28
	190°57'45" 29.195
	198°12'20" 15.425
	192°42'30" 34.01
	197°04'20" 36.02
	193°26'50" 24.485
	196°16'30" 24.125
CC	186°16'10" 29.27

LEFT BANK OF CREEK: AA - BB BY SURVEY	
BEARING	DISTANCE
AA	205°53'15" 23.17
	197°44'30" 20.695
	208°55'25" 14.52
	183°05' 24.54
	186°36'35" 17.815
	170°27'15" 15.52
	178°25'30" 16.515
	169°45'55" 20.235
	198°18'30" 25.215
	196°16'20" 13.815
	206°37'30" 14.79
	185°47'55" 30.96
	178°36'55" 29.7
	191°36'25" 14.745
BB	173°07'20" 11.505

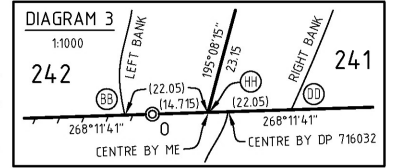
RIGHT BANK OF CREEK: CC - DD BY SURVEY	
BEARING	DISTANCE
CC	185°25'15" 22.285
	207°57'20" 19.4
	172°33' 15.625
	181°27'45" 8.18
	175°56' 7.99
	178°54'50" 36.095
	175°59'20" 10.67
	188°34' 15.675
	180°45'35" 14.3
	174°07' 22.015
	181°29'40" 13.905
	189°20'30" 11.545
	192°29'50" 4.4745
DD	202°02'10" 35.895

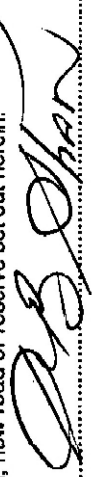

<p>Registered:  28.6.2013</p> <p>Title System: TORRENS</p> <p>Purpose: SUBDIVISION</p> <p>PLAN OF SUBDIVISION OF LOT 1 IN D.P. 137310, LOT 1 IN D.P. 137319 AND LOT 24 IN D.P. 1116230 AND RELEASE OF EASEMENT AFFECTING LOT 20 IN D.P. 1064924 AND LOT 23 IN D.P. 1116230</p>	<p>Office Use Only</p> <p style="text-align: center; font-size: 2em; font-weight: bold;">DP1185616</p> <p>Office Use Only</p>																		
<p>Crown Lands NSW/Western Lands Office Approval</p> <p>I, (Authorised Officer) in approving this plan certify that all necessary approvals in regard to the allocation of the land shown herein have been given.</p> <p>Signature:</p> <p>Date:</p> <p>File Number:</p> <p>Office:</p>	<p>Survey Certificate</p> <p>I, MARGUS ALEXANDER RATSEP of YDERMAN & RATSEP, P.O. BOX 16, BATHURST, 2795 a surveyor registered under the <i>Surveying and Spatial Information Act 2002</i>, certify that:</p> <p>“(a) The land shown in the plan was surveyed in accordance with the <i>Surveying and Spatial Information Regulation 2012</i>, is accurate and the survey was completed on 19/12/2012 and the part not surveyed was compiled in accordance with that Regulation.</p> <p>“(b) The part of the land shown in the plan (“being” excluding ^ LINES MARKED P.O.) was surveyed in accordance with the <i>Surveying and Spatial Information Regulation 2012</i>, is accurate and the survey was completed on 19/12/2012 and the part not surveyed was compiled in accordance with that Regulation.</p> <p>“(c) The land shown in this plan was compiled in accordance with the <i>Surveying and Spatial Information Regulation 2012</i>.</p>																		
<p>Subdivision Certificate</p> <p>I, DAVID ROSS SHAW *Authorised Person/*General Manager/*Accredited Certifier, certify that the provisions of s.109J of the <i>Environmental Planning and Assessment Act 1979</i> have been satisfied in relation to the proposed subdivision, new road or reserve set out herein.</p> <p>Signature: </p> <p>Accreditation number: 1889</p> <p>Consent Authority: BATHURST REGIONAL COUNCIL</p> <p>Date of endorsement: 10 April 2013</p> <p>Subdivision Certificate number: 2013183</p> <p>File number: D.A. No. 2012/0411</p> <p>* Strike through if inapplicable</p>	<p>Signature:  Dated: 23/3/2013</p> <p>Surveyor ID: 1889</p> <p>Datum Line: S.S.M. 128715 - S.S.M. 128714</p> <p>Type: *Urban/Rural</p> <p>The terrain is *Level-Undulating / *Steep-Mountainous.</p> <p>* Strike through if inapplicable. ^ Specify the land actually surveyed or specify any land shown in the plan that is not the subject of the survey.</p>																		
<p>Statements of intention to dedicate public roads, public reserves and drainage reserves.</p>	<p>Plans used in the preparation of survey/compilation.</p> <table border="0"> <tr><td>2122-3090</td><td>D.P. 1082158</td></tr> <tr><td>D.P. 137310</td><td>D.P. 1116230</td></tr> <tr><td>D.P. 137319</td><td>23382-1603</td></tr> <tr><td>D.P. 159101</td><td>23566-1603</td></tr> <tr><td>D.P. 590823</td><td></td></tr> <tr><td>D.P. 716032</td><td></td></tr> <tr><td>D.P. 817711</td><td></td></tr> <tr><td>D.P. 1042933</td><td></td></tr> <tr><td>D.P. 1064924</td><td></td></tr> </table> <p>If space is insufficient continue on PLAN FORM 6A</p>	2122-3090	D.P. 1082158	D.P. 137310	D.P. 1116230	D.P. 137319	23382-1603	D.P. 159101	23566-1603	D.P. 590823		D.P. 716032		D.P. 817711		D.P. 1042933		D.P. 1064924	
2122-3090	D.P. 1082158																		
D.P. 137310	D.P. 1116230																		
D.P. 137319	23382-1603																		
D.P. 159101	23566-1603																		
D.P. 590823																			
D.P. 716032																			
D.P. 817711																			
D.P. 1042933																			
D.P. 1064924																			
<p>Signatures, Seals and Section 88B Statements should appear on PLAN FORM 6A</p>	<p>SURVEYOR'S REFERENCE: 904.703L TDH REPORT(V1) 2013M7100(608) PARTIAL SURVEY</p>																		

PLAN FORM 6A (2012) WARNING: Creasing or folding will lead to rejection

DEPOSITED PLAN ADMINISTRATION SHEET

Sheet 2 of 3 sheets

Registered:  28.6.2013 **Office Use Only**

DP1185616

**PLAN OF SUBDIVISION OF LOT 1 IN D.P. 137310,
LOT 1 IN D.P. 137319 AND LOT 24 IN
D.P. 1116230 AND RELEASE OF
EASEMENT AFFECTING LOT 20 IN
D.P. 1064924 AND LOT 23 IN D.P. 1116230**

This sheet is for the provision of the following information as required:
- A schedule of lots and addresses - See 60(c) *SSI Regulation 2012*
- Statements of intention to create and release affecting interests in accordance with section 88B *Conveyancing Act 1919*
- Signatures and seals - see 195D *Conveyancing Act 1919*
- Any information which cannot fit in the appropriate panel of sheet 1 of the administration sheets.

Subdivision Certificate number: **2013/83**
Date of Endorsement: **10 April 2013**

PURSUANT TO SECTION 88B OF THE *CONVEYANCING ACT 1919*,

IT IS INTENDED TO RELEASE:

1. RIGHT OF CARRIAGEWAY 20 WIDE
AND VARIABLE WIDTH (D.P. 1064924)



RANDA FARAJ

CONSENT FROM WILLIAM SMEDLEY GATES AND
SUZANNE RAE GATES
MORTGAGE No. AE730275 AS REGARDS 24/1116230

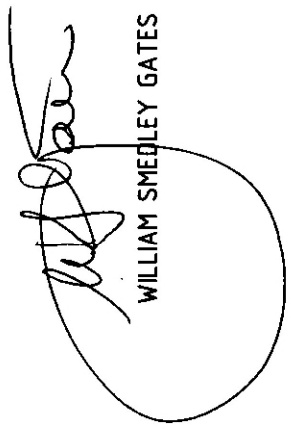

WILLIAM SMEDLEY GATES

SUZANNE RAE GATES



LOT	STREET NUMBER	STREET NAME	STREET TYPE	LOCALITY
241	1329	MID WESTERN	HIGHWAY	EVANS PLAINS
242	1457	MID WESTERN	HIGHWAY	EVANS PLAINS

If space is insufficient use additional annexure sheet

Registered:  28.6.2013 Office Use Only

PLAN OF SUBDIVISION OF LOT 1 IN D.P. 137310, LOT 1 IN D.P. 137319 AND LOT 24 IN D.P. 1116230 AND RELEASE OF EASEMENT AFFECTING LOT 20 IN D.P. 1064924 AND LOT 23 IN D.P. 1116230

Subdivision Certificate number:2013/83.....

Date of Endorsement:10 April 2013.....

DP1185616

Office Use Only



This sheet is for the provision of the following information as required:

- A schedule of lots and addresses - See 60(c) SSI Regulation 2012
- Statements of intention to create and release affecting interests in accordance with section 88B Conveyancing Act 1919
- Signatures and seals - see 195D Conveyancing Act 1919
- Any information which cannot fit in the appropriate panel of sheet 1 of the administration sheets.

JAMES ANTHONY ALLBUT

MARGARET BERYL ALLBUT
M. B. Allbut

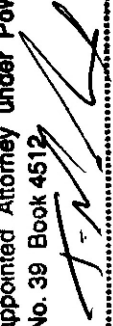
CONSENT FROM NATIONAL AUSTRALIA BANK LIMITED
 MORTGAGE No. AA416818 AS REGARDS 1/137310 AND 1/137319

Mortgagee under Mortgage No. AA416818
 Signed at Bathurst this 24th day of April 2013 for National
 Australia Bank Limited ABN 12 004 044 937
 by Timothy John Manner
 its duly appointed Attorney under Power of
 Attorney No. 39 Book 4512

 Level 3 Attorney

 Witness/Bank Officer

MICK WATTS
 103 William St
 BATHURST.

If space is insufficient use additional annexure sheet